

CONTENTS: 1 Owleez™, 1 Food (berries), 1 nest, 1 Instruction Guide

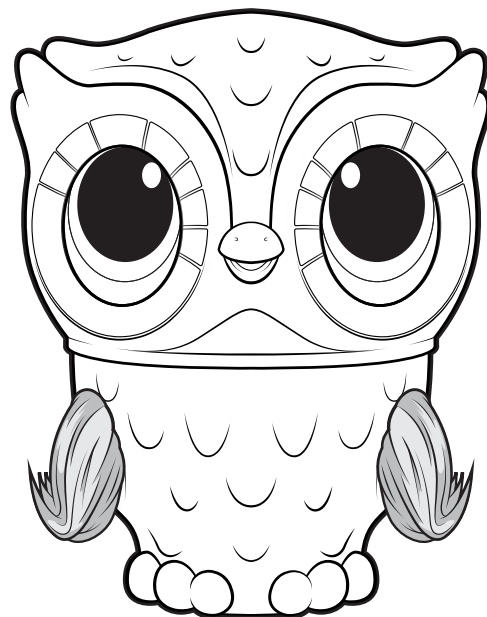

**6+**  
years

Easy to follow instruction videos: **OWLEEZ.COM**



**CAUTION:**

**HAIR ENTANGLEMENT –**  
Tie back and cover hair and secure loose clothing prior to play.



NORTH AMERICA – 1-800-622-8339,  
1-800-622-8339, [customercare@spinmaster.com](mailto:customercare@spinmaster.com)  
UK – 0800 206 1191, [serviceuk@spinmaster.com](mailto:serviceuk@spinmaster.com)  
IRELAND – 1800 992 249  
AUSTRALIA – 1800 316 982, [customercare@spinmaster.com](mailto:customercare@spinmaster.com)

[WWW.SPINMASTER.COM](http://WWW.SPINMASTER.COM)

**INDOOR USE  
ONLY**

BC



## HOW TO CHARGE

**NOTE: before playing with Owleez make sure it is fully charged.**

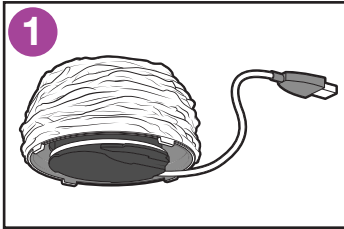

**1.** Unravel and plug the USB end of the charging cable into a computer.

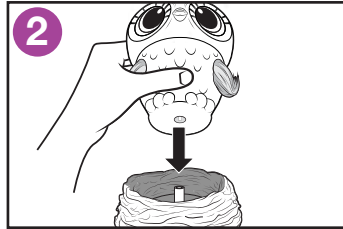

**2.** Turn your Owleez™ OFF and place your Owleez™ in the nest.

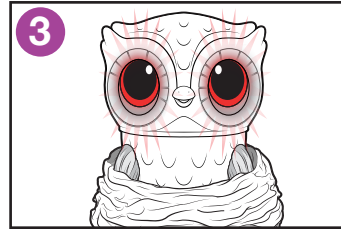

**3.** Owleez™ eyes will **pulse red** when **charging**.

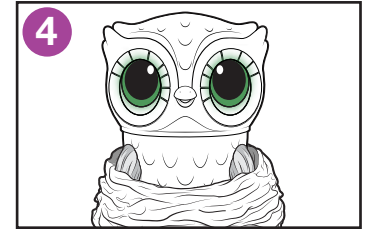

**4.** When fully charged Owleez eyes will turn **solid green**. Remove the charging cable from the power source after charging.

**NOTE: Owleez CANNOT fly while charging or while the nest is plugged in.**

**NOTE: You can play with your Owleez™ while it is turned ON and in the nest, eyes will not blink to show charging.**

**NOTE: Only connect USB charging cable to a computer.**

## MEMORY RESET

If you want to reset my flying experience (so you can teach me to fly from the start again):

Press and hold my BACK BUTTON for 10 seconds until my eyes turn white and I make a long BEEP noise. After the beep, my memory will be reset.

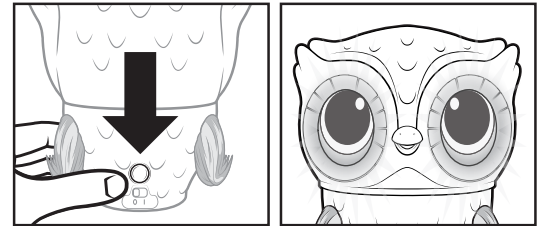

WWW.SPINMASTER.COM

2

**For TROUBLESHOOTING questions and solutions, please visit our website: OWLEEZ.COM**

**NOTE:** If normal function of the product is disturbed or interrupted, strong electromagnetic interference may be causing the issue. To reset product, turn it completely off, then turn it back on. If normal operation does not resume, move the product to another location and try again. To ensure normal performance, change the batteries, as low batteries may not allow full function.



### CONTAINS 1 X 3.7V LIPO BATTERY PACK (INCLUDED).

Batteries or battery packs must be recycled or disposed of properly. When this product has reached the end of its useful life, it should not be disposed of with other household waste. The Waste Electrical and Electronic Equipment Regulations require it to be separately collected so that it can be treated using the best available recovery and recycling techniques. This will minimize the impact on the environment and human health from soil and water contamination by any hazardous substances, decrease the resources required to make new products and avoid using up landfill space. Please do your part by keeping this product out of the municipal waste stream! The "wheele bin" symbol means that it should be collected as "waste electrical and electronic equipment". You can return an old product to your retailer when you buy a similar new one. For other options, please contact your local council.



**SPECIAL LiPo BATTERY INSTRUCTIONS:** Never charge battery unattended. - Charge battery in an isolated area. Keep away from flammable materials. - Do not expose to direct sunlight. There is a risk of the batteries exploding, overheating, or igniting. - Do not disassemble, modify, heat, or short circuit the batteries. Do not place them in fires or leave them in hot places. - Do not drop or subject to strong impacts. - Do not allow the batteries to get wet. - Only charge the batteries with the specified Spin Master™ battery charger. - Only use the batteries in the device specified by Spin Master™. - Carefully read the instruction guide and use the batteries correctly. - In the unlikely event of leakage or explosion use sand or a chemical fire extinguisher for the battery. - Batteries must be recycled or disposed of properly.

**PRODUCT BATTERY REMOVAL INSTRUCTIONS:** Internal battery is factory installed and non-replaceable. Product disassembly and battery removal must be performed by an adult. Do not puncture, cut, tear, compress or deform product during disassembly. Ensure product is turned off, then use a screw driver to remove all screws. Separate product body halves to expose internal electronics. When battery is visible in its entirety use scissors to cut a single battery wire, immediately wrap the cut wire end with tape to isolate it, repeat until all battery wires are cut and isolated, and the battery is free from the rest of the product. Dispose of battery in accordance with your local battery recycling or disposal laws.

**SPECIAL NOTE TO ADULTS:** Regularly examine for damage to the plug, enclosure and other parts. In the event of any damage, the toy must not be used with the charger until the damage has been repaired.

**SPIN MASTER LTD. 225 KING STREET WEST, TORONTO, ON M5V 3M2 CANADA**  
Imported into EU by: **SPIN MASTER INTERNATIONAL, B.V., Kingsfordweg 151, 1043 GR Amsterdam, The Netherlands** [www.spinmaster.com](http://www.spinmaster.com)  
Imported by **Spin Master Australia Pty Ltd, Suite 101. Level 1, 18-24 Chandos Street, St Leonards, NSW 2065; ☎1800 316 982**

TM & © Spin Master Ltd. All rights reserved. Retain this information, addresses and phone numbers for future reference. Children should be supervised during play. Keep away from obstacles and electrical hazards. Spin Master Ltd. reserves the right to discontinue the [www.owleez.com](http://www.owleez.com) website at any time. **MADE IN CHINA**

**APPROX. MAX ALTITUDE: 50 m (160 ft)**  
T85601\_0003\_20115990\_GEN\_IS\_R4  
T85601\_0002\_20106417\_GEN\_IS\_R4

**NOTE:** Under the environment with electrostatic discharge, the toy may malfunction and require user to reset the toy.

**CARE AND MAINTENANCE:** Wipe the toy gently with a clean damp cloth. Keep the toy away from direct heat. Do not submerge the toy in water. This can damage the electronic assemblies. This product is intended for indoor use only. Do not use outdoors - dirt, grass, cement will scratch the finish and damage the product. Do not play around water as this is a hazard and can cause a malfunction or damage the electronic assemblies. Keep the toy away from direct sunlight and/or direct heat.

### FCC STATEMENT:

This device complies with Part 15 of the FCC rules. Operation is subject to the following two conditions: (1) This device may not cause harmful interference, and (2) This device must accept any interference received, including interference that may cause undesired operation. This equipment has been tested and found to comply with the limits for Class B digital devices pursuant to Part 15 of the FCC rules. These limits are designed to provide reasonable protection against harmful interference to radio communications. This equipment generates, uses and can radiate radio frequency energy and, if not installed and used in accordance with the instruction, may cause harmful interference to radio communication. However, there is no guarantee that interference will not occur in a particular installation. If this toy does cause interference to radio or television reception (you can check this by turning the toy off and on while listening for the interference), one or more of the following measures may be useful:

- Reorient or relocate the receiving antenna
- Increase the separation between the toy and the radio or the TV
- Consult the dealer or an experienced TV-radio technician for help.

**NOTE:** Changes, adjustments or modifications to this unit, including but not limited to, replacement of any transmitter component (crystal, semiconductor, etc) could result in a violation of FCC rules under part 15 and/or 95 and must be expressly approved by Spin Master Ltd or they could void the user's authority to operate the equipment. Spin Master Inc., PMB #10053, 300 International Drive, Suite 100, Williamsville, NY 14221. To contact the responsible party please visit [fcc.spinmaster.com](http://fcc.spinmaster.com)

Do not change or modify anything on the toy.

Keep hands, hair and loose clothing away from the rotors. Do not touch the rotating rotor.

Flying the toy requires skill and children must be trained under the direct supervision of an adult.

**CAUTION:** Do not start up or fly when persons, animals or any obstructions are within the flying range of the toy.

For safe use, the room where the toy is used must be sufficiently large.

This toy is intended to be used in domestic area (house) only.

**WARNING:** Not suitable for children under 6 years of age.

**BEFORE FIRST USE:** Read the user's information together with your child.

**WARNING: ALWAYS OPERATE THE TOY AWAY FROM EYES OR FACE**

**WARNING: CHOKING HAZARD - Small parts. Not for children under 3 years.**



## CATCH THE COLOR GAME

1. PRESS and hold my BACK BUTTON until I make a twinkling noise.
2. My EYES will light up a SPECIFIC COLOR. Remember this color.
3. I will then begin to SING while my EYES cycle through different colors.
4. When they are the SAME color as the start color, TAP my FOREHEAD.

If you stop on the **right color** I will be excited (this is a WIN) (A).

If you stop on the **wrong color**, I will be sad (this is a LOSS) (B).

I will begin the next round.

5. Win three rounds and I will HAPPY DANCE.

6. Lose three rounds and the game is over and I am SAD.

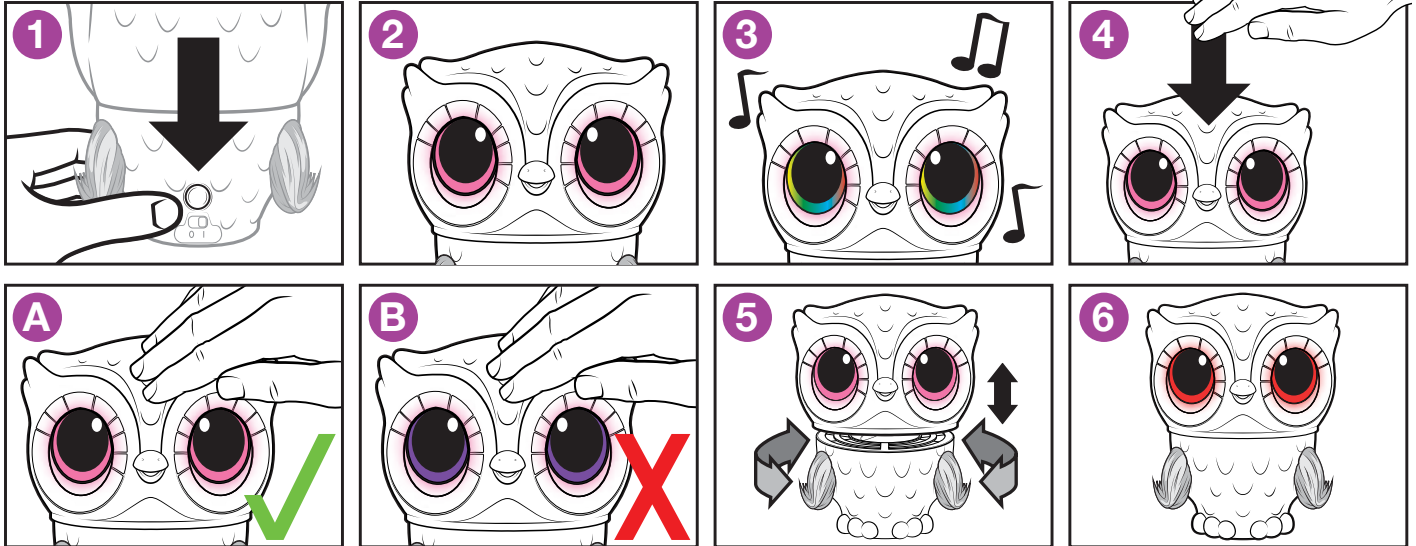

WWW.SPINMASTER.COM

12

## OWLEEZ™

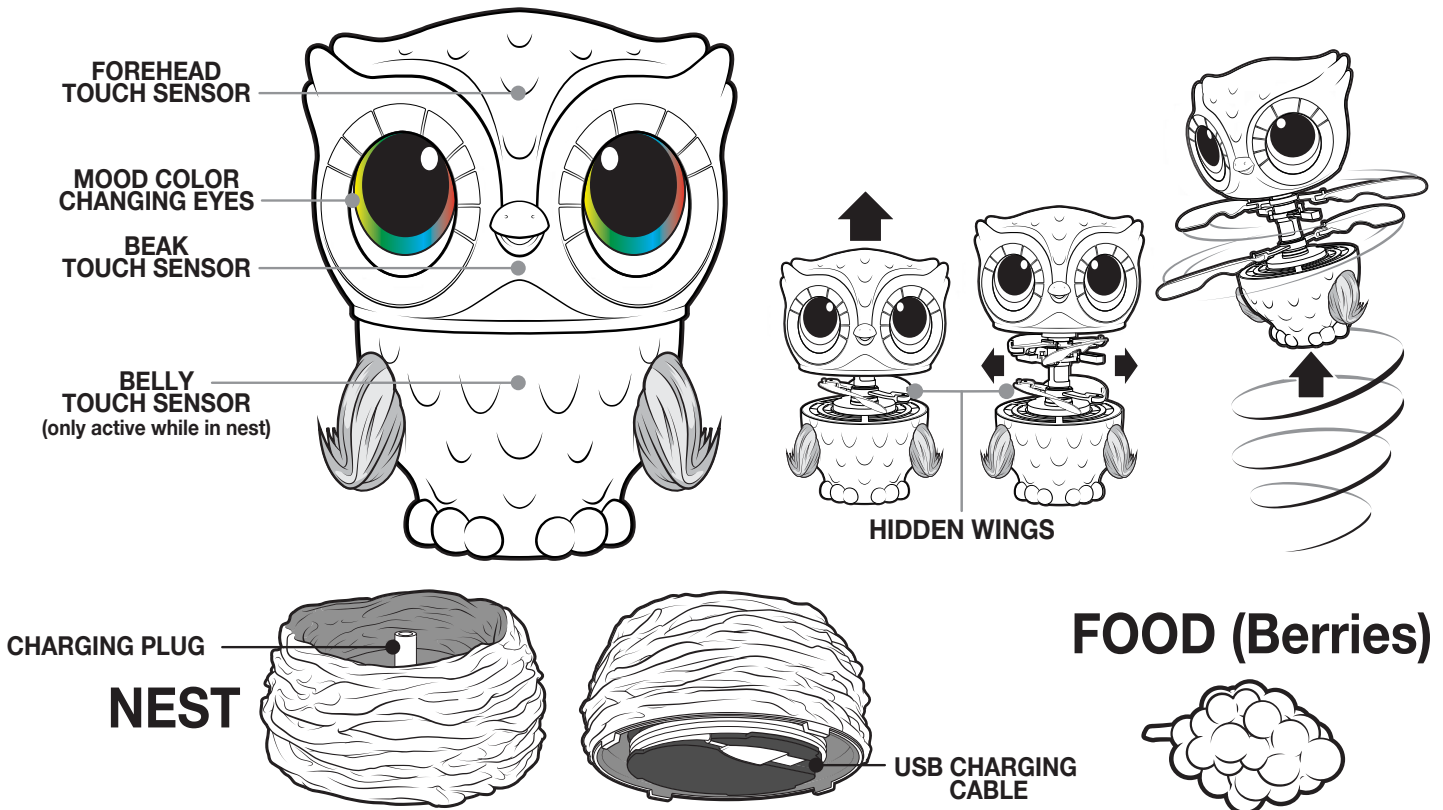

WWW.SPINMASTER.COM

3

## HOW TO TURN YOUR OWLEEZ™ ON

1. Move the ON/OFF switch to the ON position. Your Owleez™ will wake up.
2. Always remember to turn your Owleez™ OFF (O) after playing to save battery life.

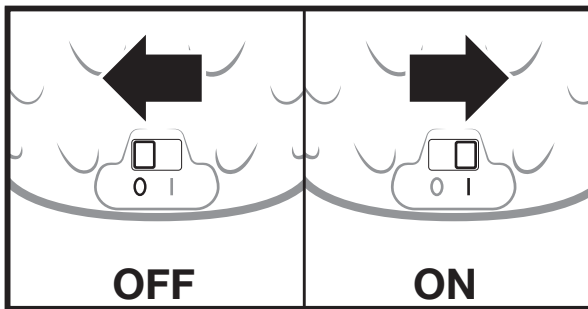

## LOW BATTERY

**NOTE:**  
Owleez™ eyes will flash RED when battery is low.

**NOTE:**  
Owleez™ CANNOT fly while charging or when battery is low.

**I AM A LITTLE OWL WHO DOESN'T KNOW HOW TO FLY.**



**I NEED YOUR HELP TO LEARN. CAN YOU TEACH ME?**

WWW.SPINMASTER.COM

4

## TROUBLESHOOTING

### CRASH OR BAD LANDING

If I have a bad landing or hit something while flying I will stop flying immediately and my eyes will turn red because I am sad.

Sit me upright so I can close my wings and pet my head to make me feel better.

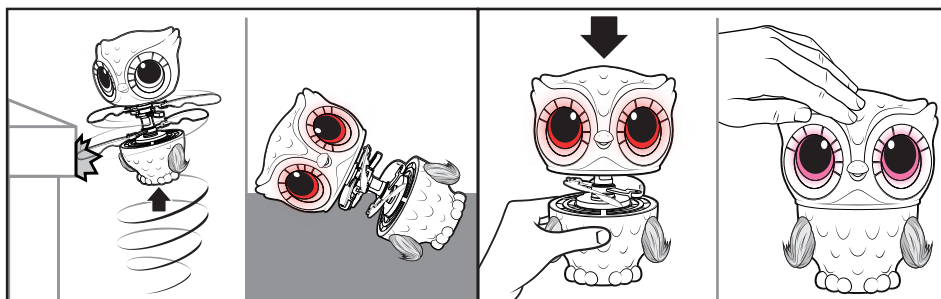

### HEAD NOT CLOSING



If my head is stuck open it is because my wings are stuck open, or caught on something inside my head. Follow the steps in "TO RAISE MY HEAD" to gently fix them.

### NOT FLYING

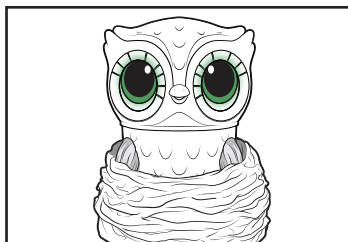

If I cannot fly, return me to the nest and allow me to fully charge before trying again.

### NOT CHARGING

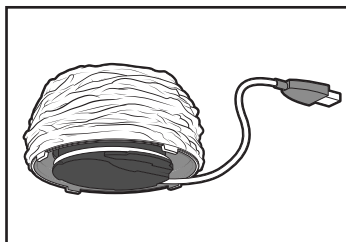

If I am not charging properly ensure my nest USB cable is plugged in to a computer. Ensure the cable is not damaged.

### TO RAISE MY HEAD

If you need to raise my head to fix my wings or if it is stuck half open after a bad flight:

- Press and hold my back button for 5 - 10 seconds. My eyes will flash red and I will make two short BEEPS, let go of my back button.
- My head will raise up for 5 seconds and my wings will attempt to curl back in.
- If you want my head to stay up, turn me OFF when it is raised.
- When you want my head to lower again, turn me ON.

### WARNING:

**DO NOT FLY ME NEAR YOUR EYES, FACE OR OTHERS.**

WWW.SPINMASTER.COM

11



## TEACH ME TO FLY (CONTINUED)

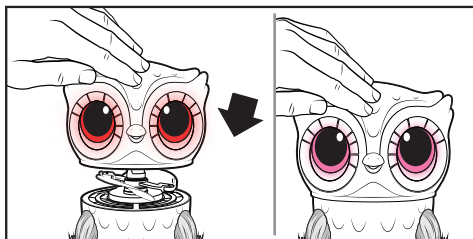

If I am not ready to fly I will close up my wings and my eyes will turn **red** because I'm sad. Pet my head to make me feel better and move me up and down again to build my confidence.

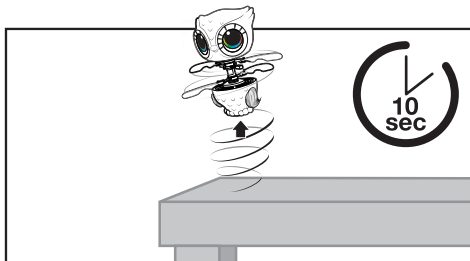

Each time I successfully fly, I will fly for a bit longer. I can fly up to a maximum of 10 seconds, then I get tired and need to land.

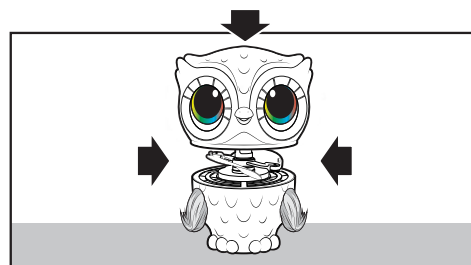

Whenever I am done flying **PLACE ME UPRIGHT ON A FLAT SURFACE** and I will try to land and curl my wings back up.

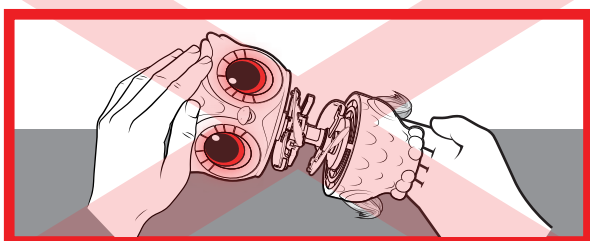

**DO NOT PUSH MY HEAD DOWN.** I close by myself when I am placed upright on a flat surface. If I do not close refer to "HEAD NOT CLOSING" on the next page.

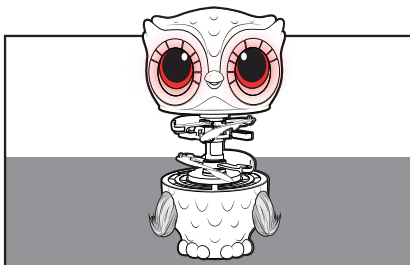

If I don't have a successful flight, I will get sad, make me happy again before trying to fly again.

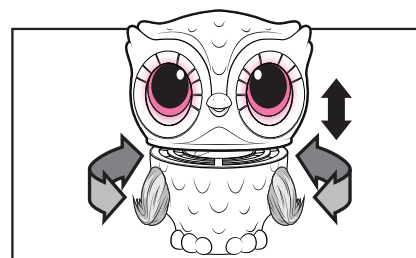

After each successful flight I will do a happy dance.

WWW.SPINMASTER.COM

10

## HOW TO PLAY

### HUNGRY

If my eyes turn **YELLOW**, it means I am HUNGRY.

Feed me my **FOOD** (berries) by touching them to me under my beak.

When I am full, I will stop making eating sounds. I will only eat if my eyes turn yellow and I am hungry. If you feed me too much I will get gassy.

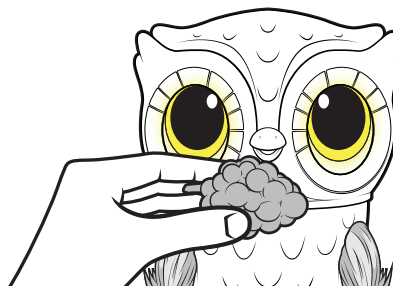

### I AM GASSY

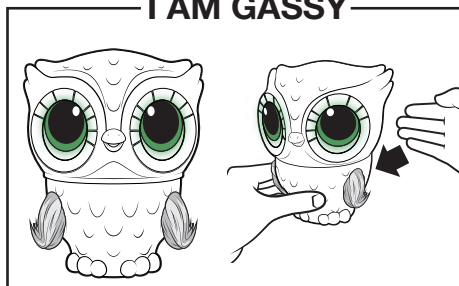

If my eyes turn **GREEN**, it means I am GASSY.

Pick me up and pat my back several times to burp me.

### I AM COLD

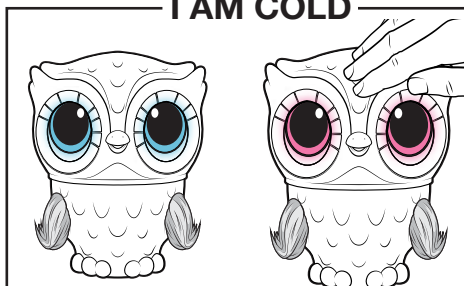

If my eyes turn **BLUE**, it means I am COLD.

Pick me up and pet my head or belly to warm me up.

### I AM SAD

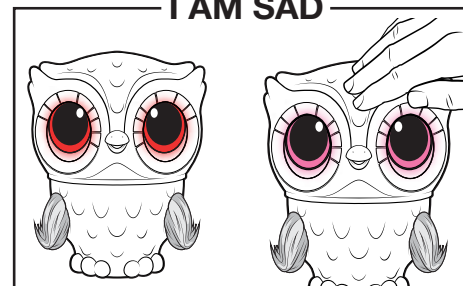

If my eyes turn **RED**, it means I am SAD.

Pick me up and pet my head to soothe me.

We encourage you to watch our how to videos at [Owleez.com](http://Owleez.com)

WWW.SPINMASTER.COM

5

## HOW TO PLAY (CONTINUED)

### PET ME

#### YOU CAN PLAY WITH ME BY:

Petting my head, chin or tummy (tummy only active while I am in my nest).

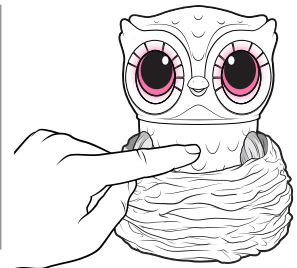
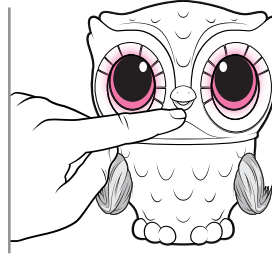

### LOVE ME

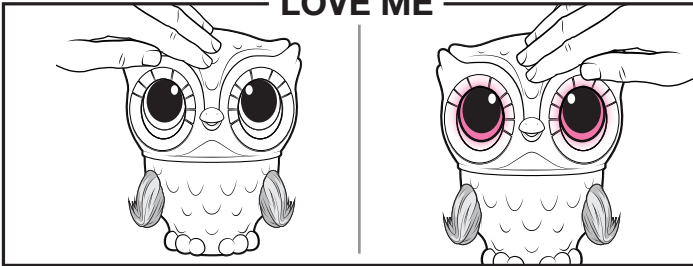

Pet me, my eyes will light up **PINK** because I love you.

### MAKE ME SING



Pick me up and **ROCK** me **SIDE TO SIDE**.

My eyes will turn **PURPLE**, I will make music and sing.

## TEACH ME TO FLY

### ATTENTION

- I CAN ONLY TAKE OFF IF I AM IN MY NEST AND IT IS NOT PLUGGED IN TO POWER.
- I CANNOT FLY IF MY BATTERY IS LOW.
- I SHOULD ONLY FLY INSIDE AN INDOOR, DRAFT FREE ENVIRONMENT.
- MAKE SURE MY NEST IS ALWAYS SITTING ON A FLAT SURFACE.
- KEEP MY NEST AT LEAST 5 FEET FROM WALLS OR OBSTACLES WHEN I AM FLYING.
- DO NOT STAND OVER ME AS I TAKE OFF.

I am a little owl who doesn't know how to fly yet, can you teach me?

Make sure my eyes are **white** then:

- **PICK ME UP, HOLD ME IN YOUR HAND, AND MOVE ME UP AND DOWN.** I WILL SAY WEEEEEEEEEE!
- This is how I learn to fly.
- When I want to try and fly on my own **my eyes will rainbow flash and I will make a trumpet noise.**
- **PLACE ME BACK IN MY NEST**, encourage me by standing back to watch me fly and give me some space since I am still learning. I will raise my head to spread my wings and fly.

#### OPTION:

Want to help me fly? Once I take off, you can put your hand under me and I will fly above your hand (optional).

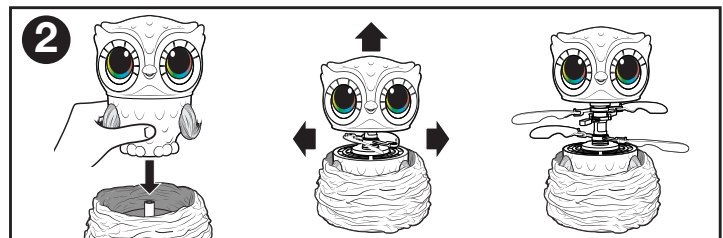
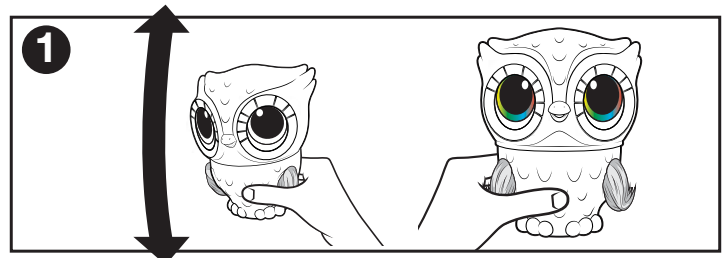

## EYE COLOR DICTIONARY

**NOTE:** before playing with Owleez make sure it is fully charged.

### WHEN YOU TURN YOUR OWLEEZ ON:

When I wake up, my eyes will light up **white** and I will make happy noises. Nurture me and take care of me.

**Pay attention to my eye color.**  
This is how you can see what I need or want.

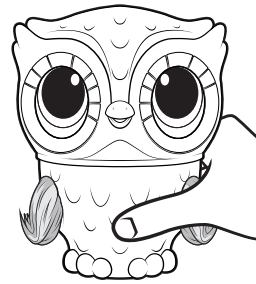

### FLASHING RED

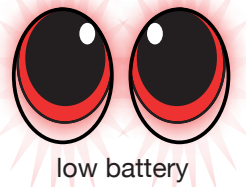

### WHITE

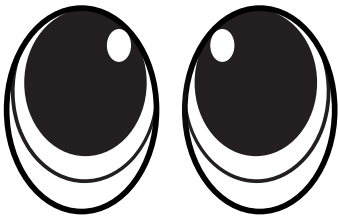

I am feeling happy

### PINK

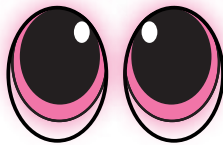

I love you

### GREEN

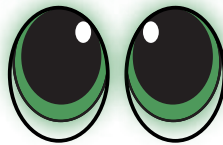

I am gassy

### YELLOW



I am hungry

### BLUE

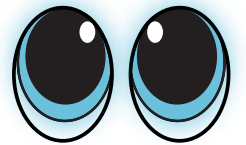

I am cold

### ORANGE



I am dizzy

### PURPLE

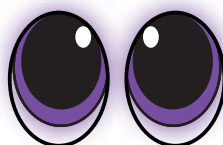

I am singing

### RED



I am sad

### RAINBOW\*

\*blinking different colours



I am  
READY TO FLY

WWW.SPINMASTER.COM

8

## HOW TO PLAY (CONTINUED)

### PUT ME TO SLEEP

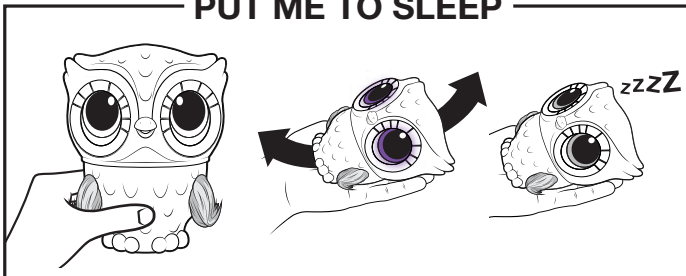

Pick me up and **ROCK** me **TO SLEEP**. Lay me on my back and I will sing a lullaby. Keep rocking me to help me fall asleep.

### WAKE ME UP

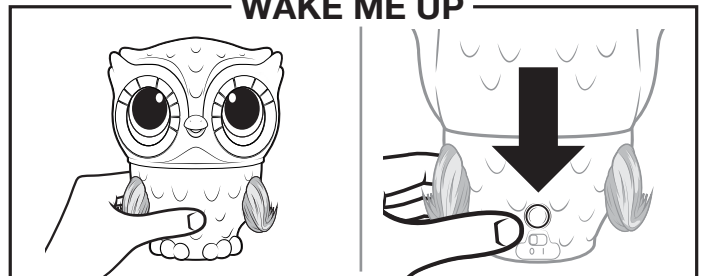

Sit me up straight and press my back button and I will wake up.

### I'M SAD

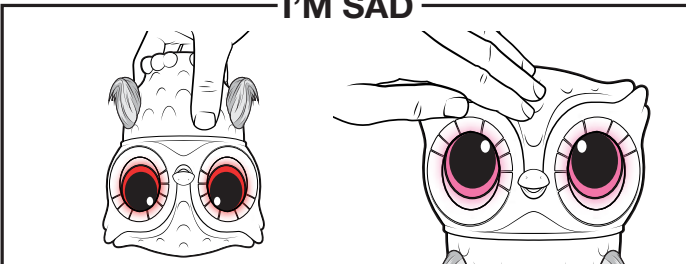

If you hold me upside down I will get upset (**red eyes**)

Sit me upright and pet my head to make me happy again.

### TICKLE ME

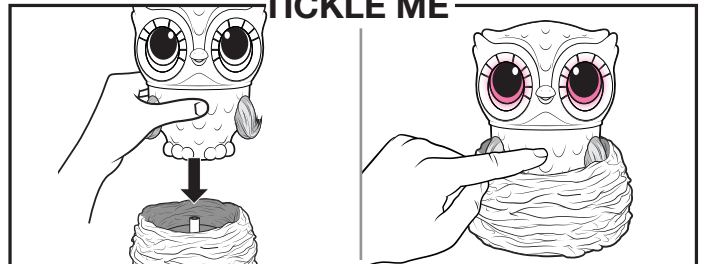

While I am in my nest, **TICKLE** my belly and I will laugh.

WWW.SPINMASTER.COM

7